



Careers Programme Study Information

Reviewed January 2025. Next Update: 3 Years.

As a primary provision, pupils at Mountfield Heath School do not undertake a specific careers programme. However, our [integrated therapeutic curriculum](#) supports pupils to be engaged, enthused and resilient, and therefore well-prepared to access the next stage of their education at secondary school. We fundamentally believe that experiencing achievement will increase our pupil's chances of living a happy life as independent, responsible, members of society.

Through our PSHE scheme, 1 Decision, pupils in KS2 are introduced to key concepts around work and employment through the module 'The Working World'.



1 Decision produces 'knowledge organisers' which outline the content, skills and learning outcomes from each module. The knowledge organiser for 'The Working World' module is attached for reference.

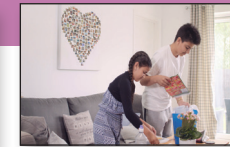

Key Facts

- For a healthy family life, it is important to care for, protect, and spend time with each other
- There are benefits to physical exercise, time outdoors, community participation, voluntary and service-based activity on mental well-being and happiness

By the end of these topics, I should:

- identify ways in which we can help those who look after us
- explain the positive impact of our actions
- describe the ways in which we can contribute to our home, school, and community
- identify the skills we may need in our future job roles

I will learn the following new words/phrases:

Income tax	<i>An employee will pay a percentage of their wages to the government.</i>
VAT	<i>An amount added to items purchased.</i>
Contribution	<i>Something you give or do that helps achieve an end result.</i>
HM Revenue and Customs	<i>The UK's tax, payments and customs authority.</i>
Society	<i>A group of people living as a community.</i>
Chore	<i>Everyday work around a house or farm.</i>
Independence	<i>Not influenced or controlled by others.</i>
Self-motivation	<i>Able and willing to work without being told what to do.</i>
Apprenticeship	<i>An arrangement in which someone learns an art, trade, or job under another.</i>
Volunteer	<i>A person who does something, especially helping other people, willingly and without being forced or paid to do.</i>
Stereotype	<i>A set idea that people have about what something or someone is like.</i>

Ask me a question!

- How can we support society, our community, and our family/friends?
- What chores could you be responsible for at home?
- Can you name any skills that may be required for a future job role?

1decision PSHE Knowledge Organiser

Module: The Working World

Topic: Enterprise and Adults' & Children's Views



Years
4-6

Key Facts

- The characteristics of healthy family life include: commitment to each other, including in times of difficulty, protection and care for children and other family members, spending time together and sharing each other's lives

I will learn the following new words/phrases:

Enterprise	A project that requires boldness or energy. A company or organisation.
Priority	The fact or condition of being regarded or treated as more important than others.
Fundraising	To generate financial support for a charity, cause, or other enterprise.

By the end of these topics, I should:

- understand and explain why people might want to save money
- identify ways in which you can help out at home
- budget for items you would like to buy
- recognise ways to make money and the early stages of enterprise

Ask me a question!

- Why do we need money?
- How can we save money?
- How can we receive money?

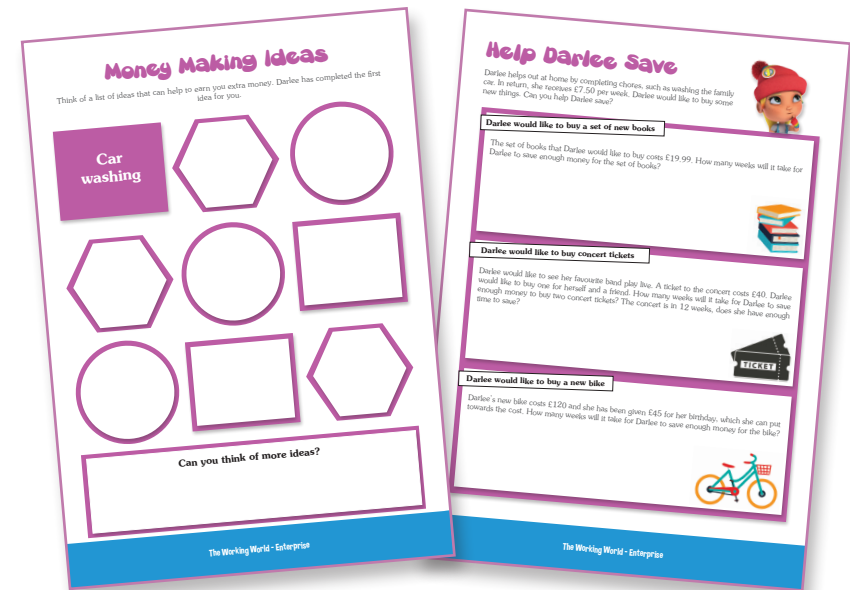



Key Facts

- It is important to give and seek permission in relationships with friends, peers, and adults
- Some social media sites, computer games and online games are age restricted

By the end of these topics, I should:

- know and understand various money-related terms
- recognise some of the ways in which we can spend money via technology
- describe the potential impact of spending money without permission
- identify strategies to save money

Ask me a question!

- How can we spend money?
- How can you help your family save money?
- Can you explain how we can spend money via technology?

I will learn the following new words/phrases:

Bank account	<i>An arrangement that allows you to keep your money in a bank.</i>
Loan	<i>An amount of money that you borrow and pay back with interest.</i>
Tax	<i>An amount of money you pay to the government.</i>
Interest	<i>You can earn a certain amount of money back when you save. Or if you have borrowed money, you may have to pay interest back.</i>
Debit card	<i>A small plastic card that allows the holder to spend their own money on goods and services.</i>
Credit card	<i>A small plastic card that allows the holder to borrow money to purchase goods or services and pay for them at a later date.</i>
Wages	<i>The amount of money your employer pays you.</i>
Debt	<i>An amount of money that you owe someone or something, such as a bank.</i>
In-app purchases	<i>Extra content or subscriptions that you buy inside an app.</i>
Budget	<i>To plan to spend money for a particular purpose.</i>
Comparison	<i>The act of showing that something is similar or equal to something else.</i>
Fairtrade	<i>A product with the FAIRTRADE Mark means producers and businesses have met internationally agreed standards which have been independently certified.</i>
Gambling	<i>The activity or practice of playing at a game of chance for money or other stakes.</i>